

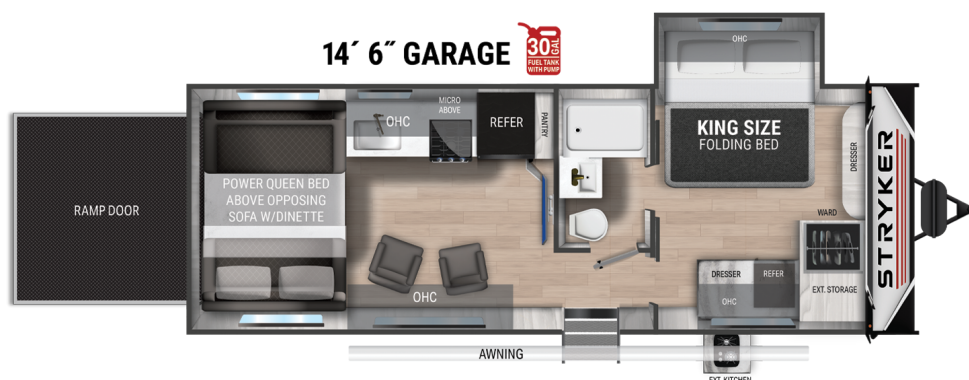

STRYKER



Top Selling Features

- Painted, molded fiberglass front cap
- Upgraded suspension with greasable shackle bolts and 16" E-Rated tires
- Azdel composite laminated sidewalls
- Generator prep with 30 gallon fuel tank and fuel pump for toys
- Easy load 8 foot ramp door with beavertail transition at garage entry
- King sized bed
- Enhance cargo space with 5,000 lb tie down rings
- Premium sound system with amplifier, subwoofer, and indoor/outdoor speakers
- Large windows with blackout roller shades
- 5/8" Tongue and groove plywood flooring

Stryker ST2714

GVWR	12,800 Lbs
Dry Weight	7,795 Lbs
Hitch Weight	1,074 Lbs
Axles	2 x 6000
Fresh Tank	98 Gal
Black Tank	30 Gal
Water Heater	10 Gal
Furnace	35,000 BTU
Air Conditioner	15,000 BTU
Number of Slides	1
Bedroom Height	7'-5"
Length	30'-11"
Awning Length	19'
Cook Top	3 Burner
Traditional Oven	Yes
Convection Oven	No
Sleep Capacity	5-6 People



www.cruiserrv.com

Cruiser RV, LLC
7805 North SR 9 • Howe, IN 46746
260-562-3500

*Overall length defined as tow point (ball coupler for travel trailers / king pin for fifth wheel trailers) to rear bumper. It does not include rear ladder or spare tire. Optional pin boxes will affect overall length. **Garage length is defined as ramp door to full interior wall. Standard or optional equipment may reduce overall garage dimensions. Information provided is accurate as of 3/3/2021 and is subject to update & change. Please confirm with your local Cruiser Dealership for up to date information.